



MODEL 2411 STEEL (RIBBED EXTERIOR) OVERHEAD DOORS

PROJECT: _____

CONTRACTOR: _____

ARCHITECT: _____

DOOR DISTRIBUTOR: _____

DRAWING No.: _____ OF _____
 SHEET No.: _____ OF _____
 DRAWN BY: _____ DATE: _____

FRAMING NOTE: WAYNE-DALTON CORP. DESIGN ENGINEERS EACH COMMERCIAL SECTIONAL OVERHEAD GARAGE DOOR FOR INDIVIDUAL APPLICATIONS BASED ON PRODUCT & OPTIONS REQUIRED. ONE, TWO OR FOUR SPRING TORSION ASSEMBLIES ARE TYPICALLY SUPPLIED AS STANDARD. DUAL TORSION SHAFT ASSEMBLIES ARE SUPPLIED WHEN REQUIRED. WHEN IT IS TIME TO PREPARE THE OPENINGS FOR INSTALLATION OF A WAYNE-DALTON PRODUCT, CONTACT OUR CUSTOMER SERVICE REPRESENTATIVES FOR MOUNTING PAD LOCATIONS.

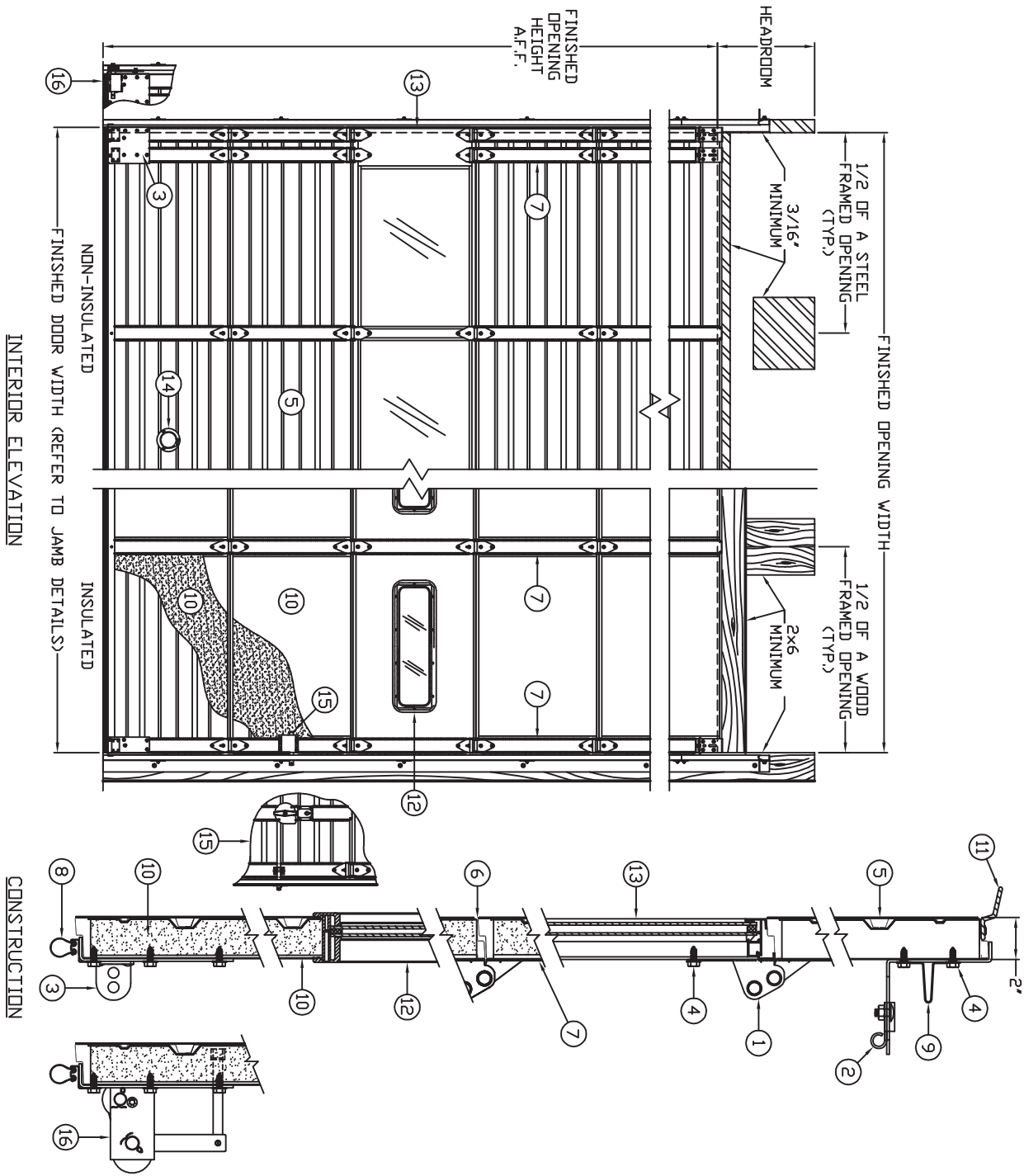

STANDARD FEATURES

1. GRADUATED HOT-DIPPED GALVANIZED STEEL END HINGES (1/4 GA. MINIMUM).
2. ADJUSTABLE HOT-DIPPED GALVANIZED STEEL TOP BRACKETS.
3. HOT-DIPPED GALVANIZED STEEL BOTTOM BRACKETS WITH CABLE ATTACHMENT.
4. (4) 1/4-20 TEK SCREWS PER HINGE & TOP BRACKET.
5. EXTERIOR OF ROLL-FORMED HOT-DIPPED GALVANIZED EMPRESSED NOMINAL 24 GA. ZINC COATED STEEL WITH 2 DEEP/4 SHALLOW HORIZONTAL RIBS. PRE-PAINTED PRIMER TO ROLL-FORMING (9 MIL POLYESTER EXTERIOR, .65 MIL POLYESTER INTERIOR).
6. SHIP-LAP MEETING RAILS:
 WHITE
 BROWN
 OPTIONAL EPDM RUBBER JOINT SEAL
7. C-SHAPED HOT-DIPPED GALVANIZED 20 GA. STEEL CENTER AND WRAP-AROUND END STILES SECURED TO ROLL-FORMED PANELS WITH ADHESIVE AND SCREWS. SINGLE END HARDWARE (UP TO 16'-2" WIDE). DOUBLE END HARDWARE (OVER 16'-2" WIDE).
8. UPGRADE TO OPTIONAL 16 GA. END STILES. HOT-DIPPED GALVANIZED STEEL RETAINER WITH "BULB-SHAPED" BOTTOM ASTRAGAL.
9. EXTERNALLY ATTACHED STRUTS AS REQUIRED.

FREQUENTLY SELECTED OPTIONS

10. 1-9/16" LAID-IN-PLACE INSULATION & BACK-UP:
 POLYSTYRENE (6.67 MATERIAL *R*-VALUE);
 VINYL BACK-UP PANELS
 WHITE EMPRESSED STEEL BACK-UP PANELS
 POLYURETHANE (100 MATERIAL *R*-VALUE);
 WHITE EMPRESSED STEEL BACK-UP PANELS
11. EPDM RUBBER TOP SECTION HEAD SEAL
 24x6 LITES:
 NON-INSULATED DOORS:
 1/8" DSB GLASS
 1/8" TEMPERED GLASS
 ACRYLIC (PLEXIGLASS) 1/8" 1/4"
 POLYCARBONATE (LEXAN) 1/8" 1/4"
 1/4" POLISHED WIRE GLASS
 INSULATED DOORS (HIGH-IMPACT POLYMER FRAMES):
 1/2" DOUBLE INSULATED SSB THERMOLITE
 1/4" ACRYLIC (PLEXIGLASS)
 1/4" POLYCARBONATE (LEXAN)
 1/4" POLISHED WIRE GLASS
 1/2" DOUBLE INSULATED TEMPERED THERMOLITE

No. SECTIONS GLAZED

13. ALUMINUM FULL VIEW SECTION: WHITE BROWN
 1/8" DSB
 1/8" ACRYLIC (PLEXIGLASS)
 1/8" TEMPERED GLASS
 1/8" POLYCARBONATE (LEXAN)
 1/4" TEMPERED PLATE GLASS
 1/4" POLISHED WIRE GLASS
 1/4" PLATE GLASS
 1/4" ACRYLIC (PLEXIGLASS)
 1/4" POLYCARBONATE (LEXAN)
 1/2" DOUBLE INSULATED (SSB GLASS)
 1/2" DOUBLE INSULATED (TEMPERED GLASS)

No. FULL VIEW SECTIONS

14. EXHAUST PORT (CENTERED BOTTOM SECTION).
 OMIT LOCKING (INSIDE SIDE LOCK STANDARD)
 STANDARD SIZE RIM CYLINDER SHIRT LOCK BAR (NOT AVAILABLE IN ALUMINUM FULL VIEW).
15. CABLE FAILURE DEVICE.
16. CABLE FAILURE DEVICE.