



THERMOMARK® 5200 RAISED PANEL INSULATED OVERHEAD DOORS

PROJECT: _____

CONTRACTOR: _____

ARCHITECT: _____

DOOR DISTRIBUTOR: _____

DRAWING No.: _____
 SHEET No.: _____ OF _____
 DRAWN BY: _____ DATE: _____

FRAMING NOTE: WAYNE-DALTON CORP. DESIGN ENGINEERS EACH COMMERCIAL SECTIONAL OVERHEAD GARAGE DOOR FOR INDIVIDUAL APPLICATIONS BASED ON PRODUCT & OPTIONS REQUIRED. ONE, TWO OR FOUR SPRING TORSION ASSEMBLIES ARE TYPICALLY SUPPLIED AS STANDARD. DUAL TORSION SHAFT ASSEMBLIES ARE SUPPLIED WHEN REQUIRED. WHEN IT IS TIME TO PREPARE THE OPENINGS) FOR INSTALLATION OF A WAYNE-DALTON PRODUCT, CONTACT OUR CUSTOMER SERVICE REPRESENTATIVES FOR MOUNTING PAD LOCATIONS.

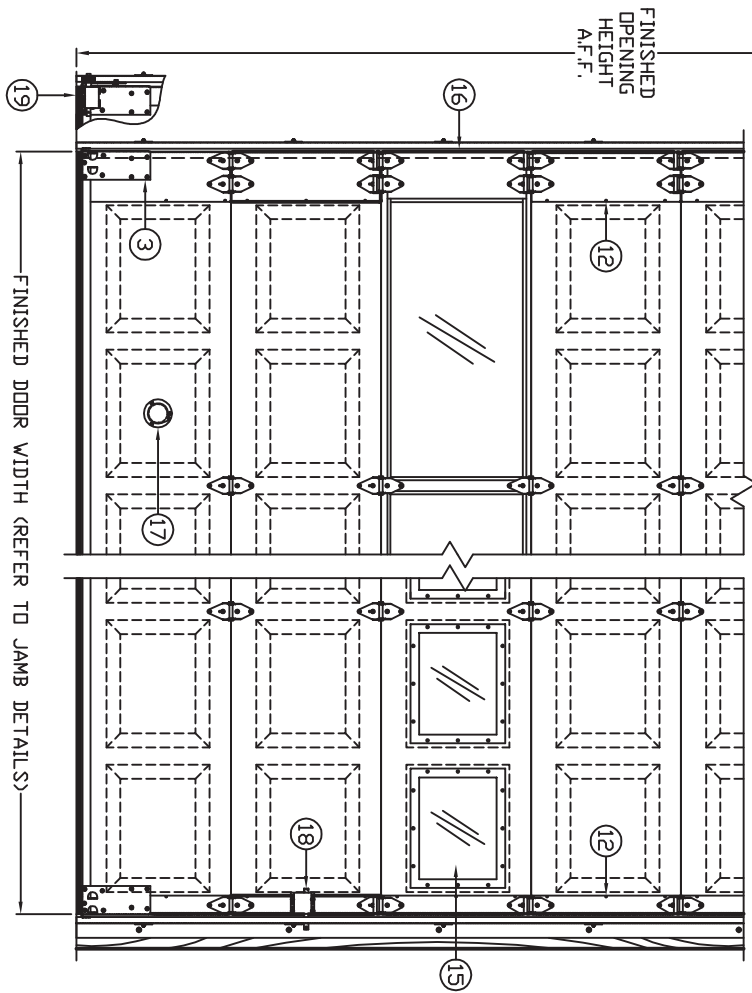
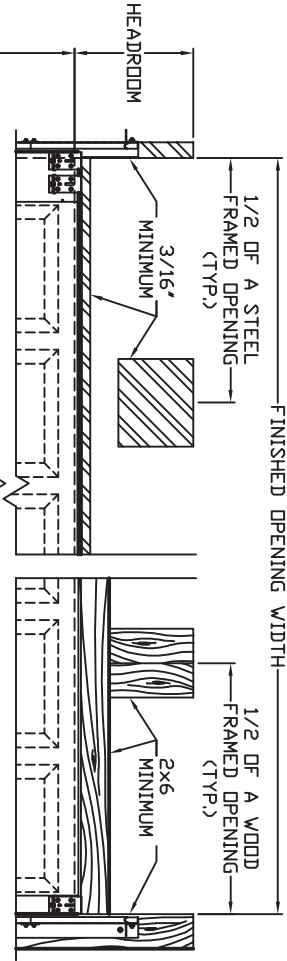
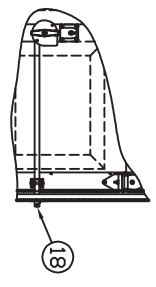

INTERIOR ELEVATION

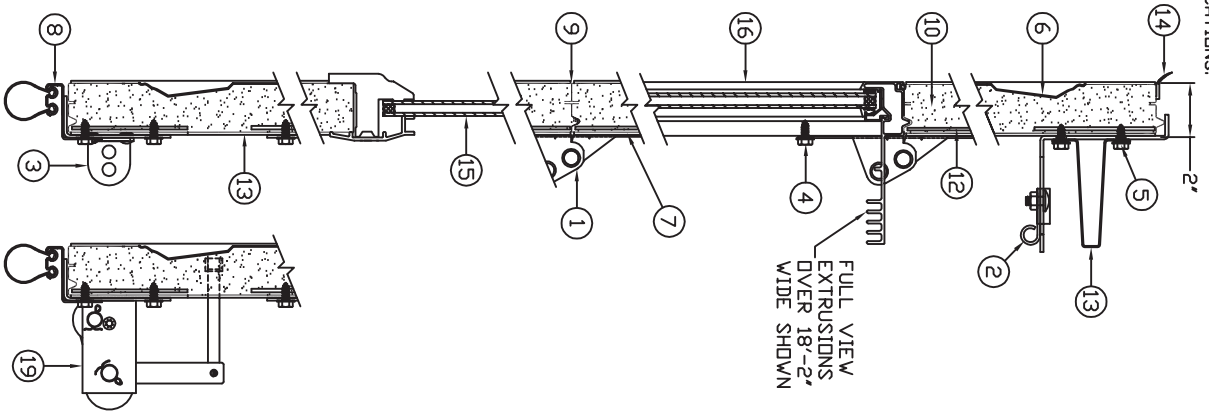

CONSTRUCTION

STANDARD FEATURES

1. GRADUATED HOT-DIPPED GALVANIZED STEEL END HINGES (14 GAUGE MINIMUM).
2. ADJUSTABLE HOT-DIPPED GALVANIZED STEEL TOP BRACKETS.
3. HOT-DIPPED GALVANIZED STEEL BOTTOM BRACKETS WITH CABLE ATTACHMENT.
4. (4) 1/4-20 TEK SCREWS PER TOP BRACKET.
5. (4) 1/4-20 TEK SCREWS PER TOP BRACKET.
6. EMBOSSED RAISED PANEL EXTERIOR-HOT-DIPPED GALVANIZED STEEL WITH EMBOSSED WOODGRAIN PATTERN. PRE-PAINTED PRIOR TO ROLL-FORMING WITH A POLYESTER FINISH COAT.
7. FLUSH INTERIOR-HOT-DIPPED GALVANIZED STEEL. SURFACE IS PRE-PAINTED PRIOR TO ROLL-FORMING WITH A POLYESTER FINISH COAT.
8. 20 GA. HOT-DIPPED GALVANIZED STEEL RETAINER WITH PVC "BULB-SHAPED" BOTTOM ASTRAGAL.
9. TONGUE & GROOVE JOINT WITH JOINT SEAL.
10. CFC FREE POLYURETHANE CORE SANDWICH-TYPE CONSTRUCTION INCLUDES THERMAL BREAKS EACH SECTION. ASHRAE CALCULATED R-VALUE = 14.80.
11. 20 GA. BUILT-IN REINFORCEMENT PLATES FOR HARDWARE ATTACHMENT.
12. HOT-DIPPED GALVANIZED STEEL WRAP-AROUND END CAPS.
13. 18 GA.-SINGLE END HARDWARE (UP TO 14'-2" WIDE), 16 GA.-DOUBLE END HARDWARE (OVER 14'-2" WIDE), EXTERNALLY ATTACHED STRUTS AS REQUIRED.

FREQUENTLY SELECTED OPTIONS

- 14. PVC TOP SECTION HEAD SEAL
- 15. COLONIAL LITES WITH HIGH-IMPACT POLYMER FRAME. 1/8" SSB GLASS 1/2" DOUBLE INSULATED SSB
- _____ No. SECTIONS GLAZED
- _____ No. LITES PER SECTION
- 16. ALUMINUM FULL VIEW SECTION: WHITE BROWN
 - 1/8" DSB
 - 1/8" ACRYLIC (PLEXIGLASS)
 - 1/8" TEMPERED GLASS
 - 1/8" POLYCARBONATE (LEXAN)
 - 1/4" TEMPERED PLATE GLASS
 - 1/4" POLISHED WIRE GLASS
 - 1/4" PLATE GLASS
 - 1/4" ACRYLIC (PLEXIGLASS)
 - 1/4" POLYCARBONATE (LEXAN)
 - 1/2" DOUBLE INSULATED (SSB GLASS)
 - 1/2" DOUBLE INSULATED (TEMPERED GLASS)
- 17. 3" EXHAUST PORT (BOTTOM SECTION).
- 18. DMT LOCKING (INSIDE SIDE LOCK STANDARD) STANDARD SIZE RIM CYLINDER SHORT LOCK BAR (NOT AVAILABLE IN ALUMINUM FULL VIEW).
- 19. CABLE FAILURE DEVICE.