

# MODEL 900

ROLLING SERVICE DOORS



## RELIABLE AND DURABLE ROLLING SERVICE DOORS

The Wayne Dalton Model 900 Rolling Service Door is ideal for jobs where an economical solution for durability and strength is needed. Model 900 offers flexibility in curtain materials with choices of galvanized steel, stainless steel, or aluminum.

Color options range from our four standard factory-finish colors to a full range of approximately 200 RAL powder coat choices.

- » SIZES UP TO 14' HIGH AND 14' WIDE
- » MAX STEEL GAUGE = 20
- » 2" FLAT AND CURVED SLATS
- » DURABLE & ECONOMICAL

# MODEL 900

## STANDARD FEATURES OVERVIEW

### CONSTRUCTION

<b>MAX HEIGHT*</b>	14'
<b>MAX WIDTH*</b>	14'
<b>MOUNTING</b>	Face-of-wall or between jambs
<b>OPERATION</b>	Manual push-up; chain hoist where door weight exceeds manual effort
<b>CURTAIN</b>	2" galvanized steel curved slats (#2 profile), primed gray, white, beige or brown; 24-gauge steel with alternating endlocks
<b>LOCKING</b>	Slide bolts on manual operation; padlockable chain keeper with chain hoist (padlock not included)
<b>BOTTOM BAR</b>	Galvanized steel double angle with weatherstrip
<b>GUIDES</b>	G-guide design; steel factory painted black
<b>BRACKETS</b>	1/4" or 3/16" steel plates with permanently sealed ball bearings
<b>COUNTER-BALANCE</b>	Steel pipe of adequate size to restrict a maximum deflection of .033" per linear foot. Oil tempered, 20,000 cycle helical springs
<b>HOOD</b>	24-gauge galvanized steel round hood; primed gray, white or beige
<b>WIND LOAD</b>	Standard wind load rated with a minimum of 20 psf *Larger sizes may be available. Contact factory for more information.

### OPTIONS

- Operation: chain hoist, motor, motor with chain hoist, wall crank, awning crank, through wall option available
- Curtain: #2 slat profile 2" curved up to 20-gauge steel; 20 or 22-gauge stainless steel; 18-gauge aluminum #17 slat profile 2" flat up to 20-gauge steel; 20 or 22-gauge stainless steel; 16 ga. extruded aluminum
- Curtain finish: stainless steel #4, mill, clear or bronze anodized aluminum, G-90 galvanized bare or painted gray, powdercoat (RAL and custom)
- Locking: slide bolts, cylinder, Best lock, thumb turns
- Guides: three angle: galvanized steel, stainless, aluminum
- Bottom bar: stainless steel or aluminum double angle, extruded aluminum angle, structural steel angle (galvanized steel only), sloped
- Bottom bar & guide finishes: Primed black finish, stainless steel #4, powdercoat (RAL and custom); hot dipped galvanized; mill, clear or bronze anodized
- Bottom edge: astragal, pneumatic or electric sensing edge
- Hood: 22-gauge steel; square hood; finishes: mill, clear or bronze anodized aluminum, bare galvanized, stainless steel #4, powdercoat (RAL and custom)
- Brackets finish: Galvanized (hot dipped), stainless steel #4, powdercoat (RAL and custom)
- Perimeter seals: angled guide brush seal, vinyl guide seal, exterior and interior lintel weather seal, internal hood baffle
- Barrel: up to 200,000 cycle barrel
- Wind load: up to +/- 31 psf
- Other options: Secur-Vent perforated slats, drop stop device, end covers, fascia, spark resistance

**Popular in both interior and exterior applications, the Wayne Dalton Model 900 Rolling Service Door features a galvanized, pre-painted curtain of minimum 24-gauge steel.**

Wayne Dalton Model 900 Rolling Service doors are composed of curved or flat-faced slats that provide a natural water-shed, helping to reduce corrosion. The slats are designed with free-acting interlocking joints that permit easy articulation when the door coils.

### MATERIALS AND CONSTRUCTION

The Model 900 features a strong double-angle bottom bar that reinforces the lower edge of the curtain against wind pressure and permits varied lock, bottom bar and safety edge options. This bottom bar is designed for easy installation and does not require fasteners protruding into the guide openings, so the bottom bar does not interfere with door operation.

The counterbalance assembly consists of a spring barrel, which serves as a load-carrying beam. It encases the counterbalance mechanism and provides the axis around which the curtain coils. Barrel rings of iron or stamped steel can be added to ensure proper counterbalance.

The counterbalance springs are wound from heat-treated steel.

The spring tension adjusting wheel is mounted outside the bracket and an inside adjusting wheel for tight applications is available.

### FINISH OPTIONS

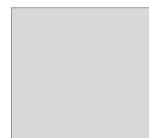

White



Gray



Beige



Brown

Actual colors may vary from brochure due to fluctuations in the printing process. Always request a color sample from your Wayne Dalton dealer for accurate color matching.

# ROLLING SERVICE DOORS



## SLAT PROFILES



No. 2 — Curved-faced single crown slat available in up to 20-gauge steel, 20-gauge stainless steel, or up to 18-gauge B&S aluminum (mill, clear, or bronze anodized). Depth of crown: 1/2", 1/8" on centers.

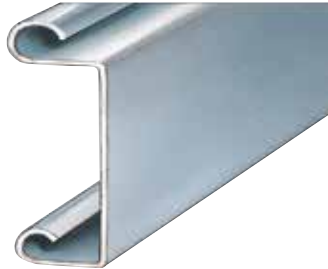

No. 17 — Flat-faced slat in up to 20-gauge steel, 20-gauge stainless steel, or 16 B&S gauge aluminum (mill, clear, or bronze anodized). Depth of crown: 1/2", 17/8" on centers.



Secur-Vent® — Perforated slat provides optimal security and ventilation. Slat consists of 1/16" diameter hole offering 20 to 25% open area over length of each slat. Available in No. 17 flat slat up to 14' wide x 12' high.



No. 2 slat.



No. 17 slat.



Combination door with Sectional and Upward Rolling Secur-Vent® Service Door.

## MODEL 900 (FACE-MOUNTED)

WIDTH A	HEIGHT B (OPENING HEIGHT)											
	8'8"				TO 14'1"				TO 16'0"			
	BRACKET SIZE		SIDE ROOM		BRACKET SIZE		SIDE ROOM		BRACKET SIZE			
	X	Y	R	L	X	Y	R	L	X	Y	R	L
CHAIN HOIST OPERATED, MOTOR OPERATED												
Up to 16'0"	14-1/2"		8"	6"	16-12"		8"	6"	18-1/2"		8"	6"
CRANK OPERATED - CONSULT FACTORY												

## MODEL 900 (BETWEEN JAMBS, UNDER LINTEL MOUNTED)

WIDTH A	HEIGHT B (OPENING HEIGHT)											
	8'8"				TO 14'1"				TO 16'0"			
	BRACKET SIZE		SIDE ROOM		BRACKET SIZE		SIDE ROOM		BRACKET SIZE			
	X	Y	R	L	X	Y	R	L	X	Y	R	L
CHAIN HOIST OPERATED, MOTOR OPERATED												
Up to 16'0"	14-1/2"		4-1/4"	4-1/4"	16-1/2"		4-1/4"	4-1/4"	18-1/2"		4-1/4"	4-1/4"
CRANK OPERATED - CONSULT FACTORY												

NOTE: Dimensions are for general reference only and not for construction purposes.



## Architect Resource Center

Visit [wayne-dalton.com/architect-resource-center](http://wayne-dalton.com/architect-resource-center) to find our Architect Resource Center. In this tool, you will quickly find all of the specifications, drawings and documents you need to complete your project.



DISTRIBUTED BY:

2501 S. State Hwy. 121 Bus., Ste 200  
Lewisville, TX 75067

[wayne-dalton.com](http://wayne-dalton.com)

